New dimensions
in freshness
Price List 2024

LIEBHERR



Global Success: The Liebherr Group

Liebherr is a third-generation, family-owned company founded by Hans Liebherr in 1949 with the creation of the first ever tower crane.

With 70 years of success, Liebherr has become synonymous with the equipment needed to build homes and businesses, as well as the appliances within them. One of the world's largest manufacturers of construction machinery, Liebherr has expanded to eleven divisions with a wide array of product ranges, including earthmoving, mining, mobile cranes, tower cranes, concrete technology, maritime cranes, aerospace and transportation systems, gear technology and automation systems, components, hotels and domestic appliances.

The company currently employs over 46,000 persons in more than 130 companies in over 50 countries worldwide. Liebherr Appliances is Europe's largest privately owned manufacturer of fridges and freezers for residential and commercial use, with an annual production of more than 2.1 million units.

Earthmoving



Mining



Mobile Cranes



Tower Cranes



Concrete Technology



Maritime Cranes



Aerospace and Transportation Systems

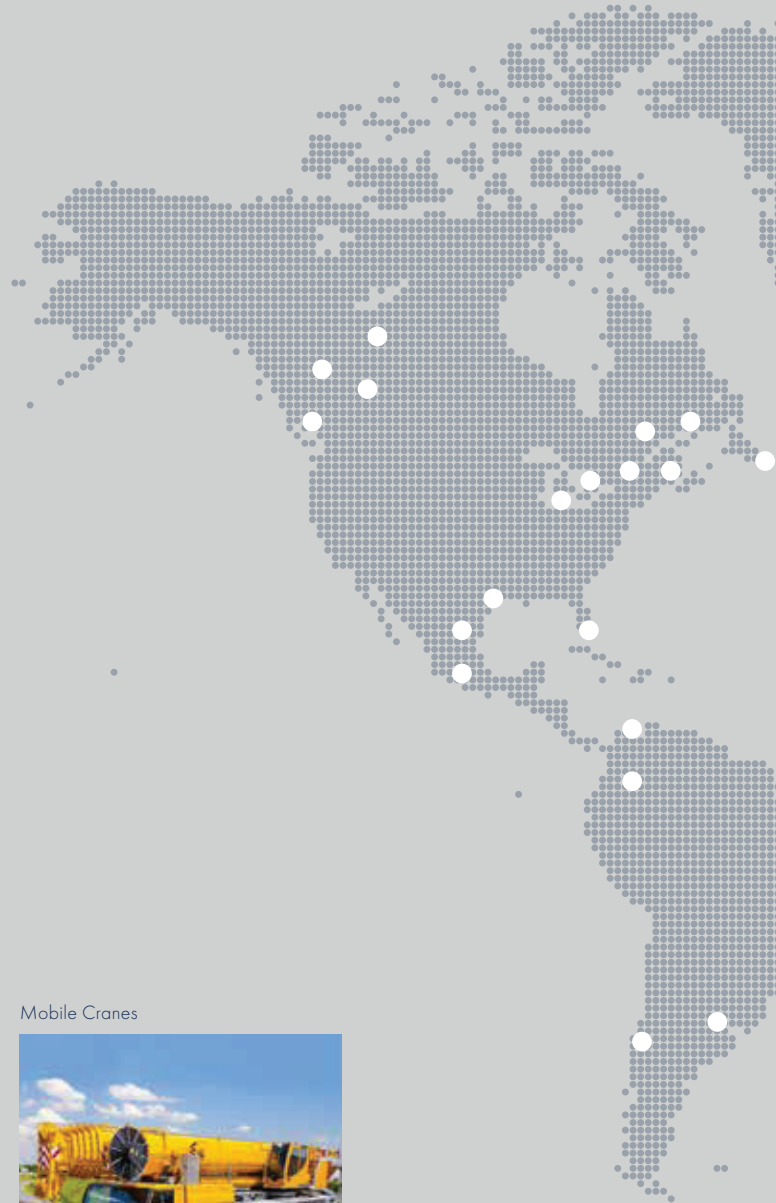



Gear Technology and Automation Systems



Domestic Appliances



Components



Hotels







Quality

Quality standards

Liebherr domestic appliances are produced under the highest international quality standard – ISO 9001 – and are compliant with the international environmental management standard – ISO 14001.

Tested quality

So that you can rely on your refrigeration appliance 24 hours a day, 365 days a year, we test every component for its long-term reliability, right from the design stage. For example, before a component such as a door hinge finds its way into production, it will first have to undergo 100,000 opening/closing cycles, which corresponds to more than 15 years of use.

Proven quality

Before packaging, every single appliance goes through a comprehensive quality inspection. This procedure tests all refrigeration technology, and all mechanical and electronic components. In addition, a visual inspection to confirm quality of workmanship also takes place.

VCC compressor

Modern speed-controlled VCC compressors deliver perfect refrigeration performance and ensure that appliances benefit from optimum energy efficiency and cost effectiveness. They operate extremely quietly.





Design

Practical design for daily use

At Liebherr, design and functionality go hand-in-hand. For example, to prevent finger marks on our stainless steel doors, we finish them with a SmartSteel surface and, to make door opening easy and convenient, our ergonomically designed handles house an integrated opening mechanism; not to mention that all GlassLine shelves are dishwasher safe.

Lighting design

Liebherr's fridges and freezers are fitted with modern LED lighting. Upon opening the appliance door, the interior becomes evenly illuminated. LEDs are long-life, energy-efficient and generate hardly any heat. We take meticulous care to install specially selected LEDs in order to achieve a harmonious, slightly bluish tinted lighting effect.

Award-winning design

The superb design quality of our appliances has seen them honoured with many prestigious, international design awards from the likes of Plus X Award, reddot and German Design Award.



BluPerformance





Innovation

Innovative ideas

Liebherr integrates style, function and technology: BioFresh, SuperCool and SuperFrost are just a few examples of performance features that contribute to better food preservation. Accurate and independent temperature control of the fridge and freezer compartments is facilitated by DuoCooling: two separately adjustable cooling circuits. There is no air exchange between the fridge and freezer compartment, so that odours cannot be transferred and the stored food is prevented from drying out.

ActiveGreen initiative

A concept that best represents Liebherr's commitment to finding greener ways to produce quality, sustainable products. Liebherr was the first refrigeration manufacturer to be RoHS compliant worldwide by restricting the use of hazardous substances. Energy efficiency is at the core of our ActiveGreen commitment, which is reflected in every aspect of our design and manufacturing process.

Energy efficiency

Liebherr refrigerators and freezers help to produce less energy waste and greenhouse gas emissions with the aim to have the least damaging effect on the environment and offering solutions that help consumers conserve energy.



BioFresh: enjoy lasting freshness

With BioFresh technology, food keeps fresh for much longer. When stored at a temperature close to 0°C and at the correct humidity level, many foods retain their nutrients, such as vitamins and minerals, for far longer than in a conventional fridge compartment.

Considerably longer shelf life

It is important for newly purchased and freshly harvested foods to be stored properly so that their nutrients are preserved for longer.

The dry conditions in the **DrySafe** are ideal for storing meat, fish and dairy products.

The shelf life and freshness of most fruit and vegetables can be significantly extended by storing them in a fridge, particularly in the **Fruit & Vegetable safe**. The high humidity in this storage environment means less liquid is lost from food, keeping fruit and vegetables fresh and crisp. By adjusting to low humidity, the Fruit & Vegetable safe can also be used as an additional DrySafe.

Less packaging is better for the environment

More and more packaging waste is being produced, which is harmful to our environment. This is one of the reasons why the Fruit & Vegetable safe was developed. Here, fruit and vegetables are best stored unpackaged and they also maintain their freshness for longer. This means there's nothing to stop you shopping at the farmer's market or in the packaging-free supermarket. The practical FlexSystem (depending on model) helps to separate and sort products neatly and cleanly.

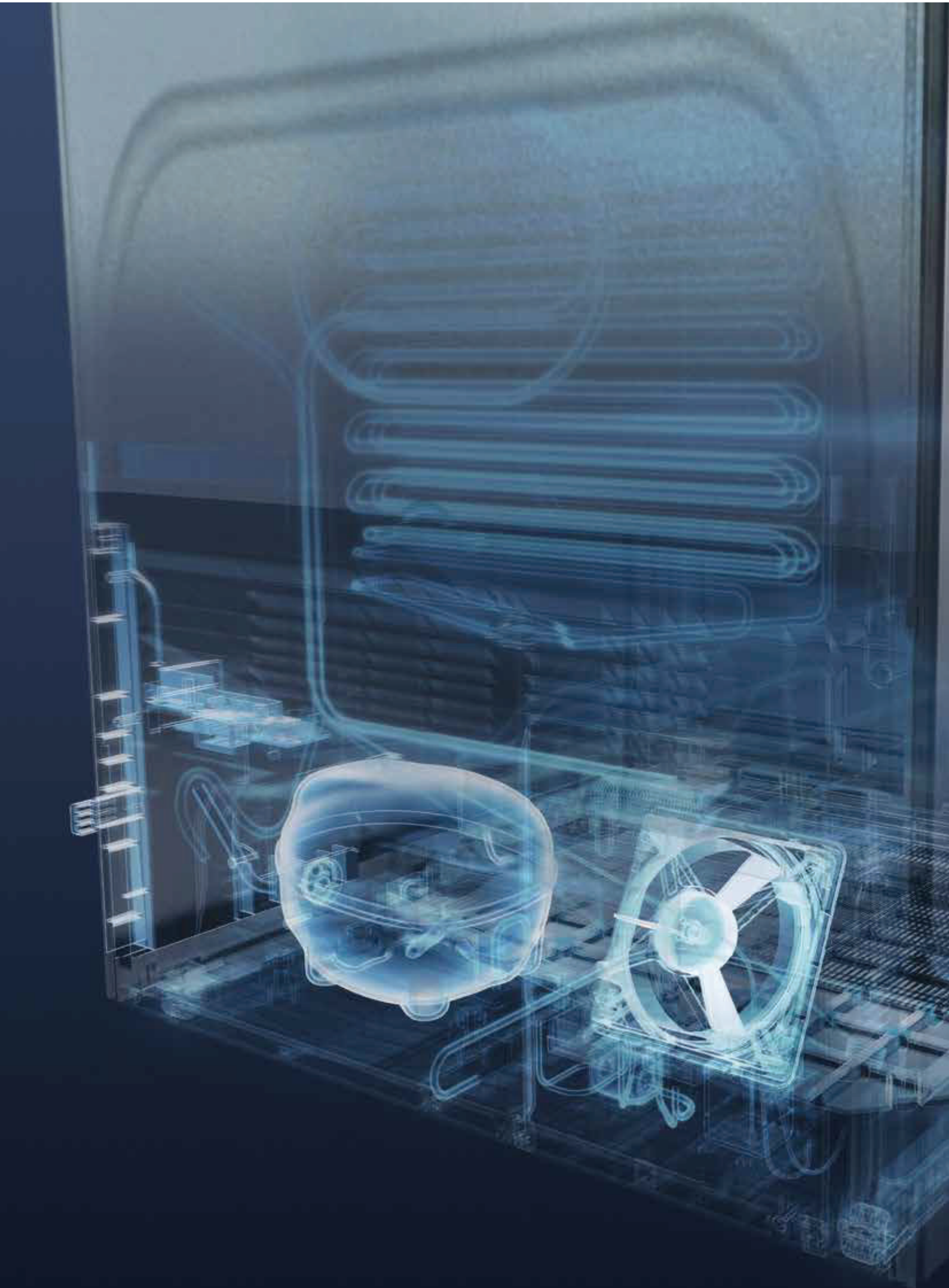

BluPerformance

A new dimension in refrigeration design

High quality materials, meticulous workmanship in every detail, and easy-to-use, precise touch-electronics define the BluPerformance range.

The compact integration of cooling technology into the appliance plinth and the use of precision electronic controls have enabled even greater energy efficiency, provided more usable volume, and improved freezer compartment ergonomics.

BioFresh and BioCool ensure lasting quality and freshness for stored foods. In addition, these models are quieter than ever, so they will not disturb your living environment.

With an elegant and timeless design, BluPerformance appliances are a highlight in any kitchen and are guaranteed to be a pleasure to use for many years to come.



SIFNh 5188

Freestanding



Side-by-Side

SBSes 8486
SBSes 8474
SBSeF 7242
SBSbs 8673



Frenchdoor

CBNes 6256

Fridge-Freezer

CNPef 4516

Fridge

SKBbs 4350



Wine Cabinets

WKb 4612
WKb 4112
WKb 1712



Design & Lifestyle

FKv 503

Fully Integrated



Frenchdoor

ECBN 6256



Fridge-Freezer

ICBNh 5173
ICNh 5133
ICNh 5103

Fridge

IRBh 5120
IRBh 5170

Freezer

SIFNh 5128
SIFNh 5188



Undercounter

SUIKo 1550
SUIK 1510



Wine Cabinets

EWtdf 3553
UWTgb 1682
UWTes 1672
WKEgb 582



SBSes 8486

Freestanding Appliances

Side-by-side



SBSes 8486

Features

BioFresh Plus
NoFrost
IceMaker
Wine with Multi
Temperature Zone
SoftSystem, SmartSteel

Recess Dimensions

in CM (H/W/D)
185 / 121 / 66.5

MRP

₹8,98,990/-



SBSes 8474

Features

BioFresh
NoFrost
IceMaker
SoftSystem
SoftTelescopic
SmartSteel

Recess Dimensions

in CM (H/W/D)
185 / 121 / 66.5

MRP

₹6,99,990/-



SBSef 7242

Features

NoFrost
SmartSteel

Recess Dimensions

in CM (H/W/D)
185.2 / 121 / 62.3

MRP

₹3,99,990/-



SBSbs 8673

Features

Bio Fresh
Black Steel
Soft System
Auto Ice-maker

Recess Dimensions

in CM (H/W/D)
185 / 121 / 66.5

MRP

₹5,84,990/-



CNPet 4516

Freestanding Appliances

Frenchdoor



CBNes 6256

Features

BioFresh
NoFrost
DuoCooling
IceMaker

Recess Dimensions

in CM (H/W/D)
203.9 / 91 / 61.5

MRP

₹ 8,29,990/-

Fridge - Freezer



CNPef 4516

Features

NoFrost
DuoCooling
SmartSteel

Recess Dimensions

in CM (H/W/D)
185.9 / 74.7 / 63

MRP

₹ 1,92,990/-

Fridge



SKBbs 4350

Features

Black Matt Smart Steel Finish
BioFresh
NoFrost
SmartSteel
SuperCool
SoftSystem

Recess Dimensions

in CM (H/W/D)
185 / 60 / 60

MRP

₹ 2,79,990/-



IRBh 5170

Fully Integrated Appliances

Frenchdoor



ECBN 6256

Features

BioFresh
NoFrost
DuoCooling
IceMaker
SoftSystem

Recess Dimensions

in CM (H/W/D)
202.7 / 91 / 61

MRP

₹8,89,990/-

Freezer



SIFNh 5188

Features

Ice system
Soft System
Soft Telescopic
Rails

Recess Dimensions

in CM (H/W/D)
177.2-178.8 / 56-57 / 55

MRP

₹2,99,990/-



SIFNh 5128

Features

No frost
Soft System
Touch
display

Recess Dimensions

in CM (H/W/D)
177.2-178.8 / 56-57 / 55

MRP

₹2,24,990/-



ICBNh 5173

Fully Integrated Appliances

Fridge - Freezer



ICNh 5133

Features

Ice maker
Water tank
Soft System
No frost

Recess Dimensions

in CM (H/W/D)
177.2-178.8 / 56-57 / 55

MRP

₹3,34,990/-



ICBNh 5173

Features

Bio fresh Professional
Hydro breeze
Glass and
Steel interior
Auto Ice maker

Recess Dimensions

in CM (H/W/D)
177.2-178.8 / 56-57 / 55

MRP

₹3,94,990/-



ICNh 5103

Features

Easy Fresh
No frost
Duo Cooling

Recess Dimensions

in CM (H/W/D)
177.2-178.8 / 56-57 / 55

MRP

₹2,57,990/-

Fridge



IRBh 5120

Features

Bio Fresh
Soft System
Touch
Display

Recess Dimensions

in CM (H/W/D)
177.2-178.8 / 56-57 / 55

MRP

₹2,24,990/-



IRBh 5170

Features

Bio fresh Professional
Hydro breeze
Soft System
Glass and Steel Door Interior

Recess Dimensions

in CM (H/W/D)
177.2-178.8 / 56-57 / 55

MRP

₹3,09,990/-



SUIKo 1550

Undercounter Appliances

Fridges



SUIK 1510

Features
SoftSystem

Recess Dimensions
in CM (H/W/D)
82-88 / 59.7 / 55

MRP
₹ 1,59,990/-



SUIKo 1550

Features
SoftSystem

Recess Dimensions
in CM (H/W/D)
82-88 / 59.7 / 55

MRP
₹ 2,09,990/-



Wkb 4612

Free Standing Wine Cabinets

Barrique



WKb 4612

Features

LED

Wine

Recess Dimensions

in CM (H/W/D)

184.2 / 65.7 / 66.3

MRP

₹ 2,23,990/-



WKb 4112

Features

LED

Wine

Recess Dimensions

in CM (H/W/D)

164.5 / 65.7 / 66.3

MRP

₹ 1,72,990/-



WKb 1712

Features

LED

Wine

Recess Dimensions

in CM (H/W/D)

85 / 65.7 / 66.3

MRP

₹ 1,36,990/-



EWTdf 3553

Shown here with optional stainless steel fronts and frames and stainless steel handles (available as accessory)

Fully Integrated Wine Cabinets

Vinidor



EWTdf 3553*

Features

LED
Wine
SoftSystem
Telescopic Rails
Multi-Zone Temperature

Recess Dimensions

in CM (H/W/D)
177 / 55.7 / 55.3

MRP

₹ 4,84,990/-

Steel Door Frame needs to be ordered separately.

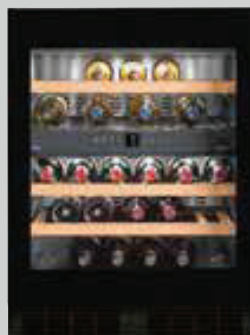

UWTgb 1682

Features

LED
Wine
Tip Open
SoftSystem
Telescopic Rails
Multi-Zone Temperature

Recess Dimensions

in CM (H/W/D)
81.8 / 59.7 / 57.5

MRP

₹ 4,38,990/-



UWTes 1672

Features

LED
Wine
Telescopic Rails
Multi-Zone Temperature

Recess Dimensions

in CM (H/W/D)
81.8 / 59.7 / 57.5

MRP

₹ 3,29,990/-

GrandCru



WKEgb 582

Features

LED
Wine
Tip Open
SoftSystem
Telescopic Rails

Recess Dimensions

in CM (H/W/D)
44.8 / 55.5 / 55.9

MRP

₹ 2,79,990/-



UWTes1672

Design and Lifestyle Appliances

Beverage Centre



FKv 503

Features

Stainless Steel,
Led Ceiling Light

Recess Dimensions

in CM (H/W/D)
612 / 450 / 425

MRP

₹1,56,990 /-



Technical Specifications

Freestanding Appliances



	SBSes 8486 PremiumPlus	SBSes 8474 Premium
	<div>Bio Fresh-Plus</div> <div>No Frost</div> <div>Ice Maker</div> <div>Wine</div> <div>Soft System</div> <div>Soft Telescopic</div> <div>Smart Steel</div>	<div>Bio Fresh</div> <div>No Frost</div> <div>Ice Maker</div> <div>Soft System</div> <div>Soft Telescopic</div> <div>Smart Steel</div>
Max. No. of Bordeaux bottles (0.75l) ²	48	-
Refrigerator capacity litre (gross/net)	586 / 519	602 / 539
BioFresh comp. litre (gross/net)	163 / 132 (Included in Fridge)	352 / 305 (Included in Fridge)
Freezer capacity litre (gross/net)	154 / 126	154 / 126
Energy consumption (kWh/y) ¹	405	406
Number of shelves refrigerator compartment	6	8
Number of shelves wine compartment	4	-
Number of door racks	5	5
Number of freezer drawers	5 with LED lighting	5 with LED lighting
Number of BioFresh drawers	3 with LED lighting	5 with LED lighting
Electronic control	2.4" TFT-colour temp. display, touch electronic	2.4" TFT-colour temp. display, touch electronic
Refrigerator temperature range °C	+2°C to +9°C	+2°C to +9°C
Freezer temperature range °C	-14°C to -26°C	-14°C to -26°C
Climate class	SN-T	SN-T
Temperature alarm	Visual and acoustic	Visual and acoustic
Defrost type	Automatic	Automatic
Interior light	LED ceiling lighting with dimmer function	LED ceiling lighting with dimmer function
Door alarm	Visual and acoustic	Visual and acoustic
IceMaker	Fixed water connection 3/4"	Fixed water connection 3/4"
Ice cube output kg/24h	1.2	1.2
SoftSystem	Yes	Yes
Door hinges	Left / right	Left / right
Product dimensions (H/W/D) cm ¹	185 / 121 / 66.5	185 / 121 / 66.5
Net weight kg	178.7	163
Voltage V	220-240	220-240
Door/side walls	Stainless steel with SmartSteel / stainless steel with SmartSteel	Stainless steel with SmartSteel/stainless steel with SmartSteel
Installation Diagrams		

¹ To achieve the indicated energy consumption level, the wall spacers provided with the appliance must be used. These increase the appliance depth by approximately 3.5 cm and 1.5 cm for BluPerformance-appliances. If the wall spacers are not used, the appliance will remain fully functional, but will have a slightly higher energy consumption level.
² These models are only bound for storing wine. Maximum DIN norm bordeaux bottles capacity (0.75 l) as per norm NF H 35-124 (H: 300.5 mm, Ø 76.1 mm).

Freestanding Appliances



121



121

SBSbs 8673

No Frost Smart Steel

SBSe7 7242 Comfort

No Frost Smart Steel

Max. No. of Bordeaux bottles (0.75l) ²
Refrigerator capacity litre (gross/net)
BioFresh comp. litre (gross/net)
Freezer capacity litre (gross/net)
Energy consumption (kWh/y) ¹
Number of shelves refrigerator compartment
Number of shelves wine compartment
Number of door racks
Number of freezer drawers
Number of BioFresh drawers
Electronic control
Refrigerator temperature range °C
Freezer temperature range °C
Climate class
Temperature alarm
Defrost type
Interior light
Door alarm
IceMaker
Ice cube output kg/24h
SoftSystem
Door hinges
Product dimensions (H/W/D) cm ¹
Net weight kg
Voltage V
Door / side walls

411/367	393 / 381
164/133 (Included in Fridge)	-
315/262	303/253
388	589
6	7
-	-
5	5
9 with LED lighting	8
3 with LED lighting	-
2.4" TFT-colour temp. display, touch electronic	MagicEye with digital temp. display, touch electronic
+2 °C to +9 °C	+3°C to +9°C
-14 °C to -28 °C	-14°C to -26°C
SN-T	SN-T
Visual and acoustic	Visual and acoustic
Automatic	Automatic
LED ceiling lighting with dimmer function	LED ceiling ighting
Visual and acoustic	Acoustic
Fixed water connection 3/4"	-
0.8	-
Yes	-
Left / right	Left/right
185 / 121 / 66.5	185.2/121/62.3
170	151.7
220 – 240	220 –240
Black steel with SmartSteel / black steel with SmartSteel	Stainless steel with SmartSteel / silver

Installation Diagrams

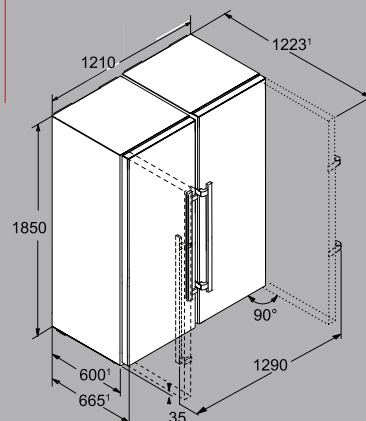
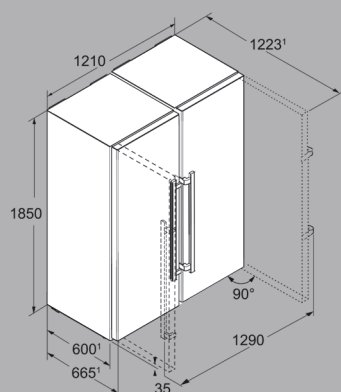

Freestanding Appliances



	<div>SKBbs 4350 Premium</div> <div><div>Bio Fresh</div><div>Soft System</div><div>Soft Telescopic</div><div>Smart Steel</div></div>
Max. No. of Bordeaux bottles (0.75l) ²	2
Refrigerator capacity litre (gross/net)	411 / 367
BioFresh comp. litre (gross/net)	161 / 133
Freezer capacity litre (gross/net)	-
Energy consumption (kWh/y) ¹	194
Number of shelves refrigerator compartment	6
Number of shelves wine compartment	-
Number of door racks	-
Number of freezer drawers	-
Number of BioFresh drawers	3
Electronic control	2.4" Touch TFT colour display with digital temperature display
Refrigerator temperature range °C	+2 °C to +9 °C
Freezer temperature range °C	-
Climate class	SN-T
Temperature alarm	-
Defrost type	Automatic
Interior light	LED ceiling light
Door alarm	Acoustic
IceMaker	Yes
Ice cube output kg/24h	-
SoftSystem	-
Door hinges	Right interchangeable
Product dimensions (H/W/D) cm ¹	185 / 60 / 66.5 cm
Net weight kg	79
Voltage V	220-240
Door/side walls	Glass with stainless steel trim
Installation Diagrams	

Freestanding Appliances



◀ 91 ▶



◀ 75 ▶

CBNes 6256 PremiumPlus



CNPef 4516 Comfort



Max. No. of Bordeaux bottles (0.75l) ²

Refrigerator capacity litre (gross/net)

BioFresh comp. litre (gross/net)

Freezer capacity litre (gross/net)

Energy consumption (kWh/y) ¹

Number of shelves refrigerator compartment

Number of shelves wine compartment

Number of door racks

Number of freezer drawers

Number of BioFresh drawers

Electronic control

Refrigerator temperature range °C

Freezer temperature range °C

Climate class

Temperature alarm

Defrost type

Interior light

Door alarm

IceMaker

Ice cube output kg/24h

SoftSystem

Door hinges

Product dimensions (H/W/D) cm ¹

Net weight kg

Voltage V

Door/side walls

Installation Diagrams

402 / 364

73 / 69 (Included in Fridge)

183 / 116

517

4

6

2 with LED lighting

2 with LED lighting

MagicEye with digital temp. display, touch electronic

+3°C to +9°C

-14°C to -28°C

T

Visual and acoustic

Automatic

LED light column on both sides and LED ceiling lighting

Acoustic

Fixed water connection 3 / 4"

1.3

Left/right

203.9/91/61.5

168

220-240

Stainless steel / stainless steel

Stainless steel / stainless steel

Stainless steel / stainless steel

Stainless steel / stainless steel

Stainless steel / stainless steel

Stainless steel / stainless steel

Stainless steel / stainless steel

Stainless steel / stainless steel

Stainless steel / stainless steel

Stainless steel / stainless steel

Stainless steel / stainless steel

Stainless steel / stainless steel

Stainless steel / stainless steel

Stainless steel / stainless steel

Stainless steel / stainless steel

Stainless steel / stainless steel

Stainless steel / stainless steel

Stainless steel / stainless steel

Stainless steel / stainless steel

Stainless steel / stainless steel

Stainless steel / stainless steel

Stainless steel / stainless steel

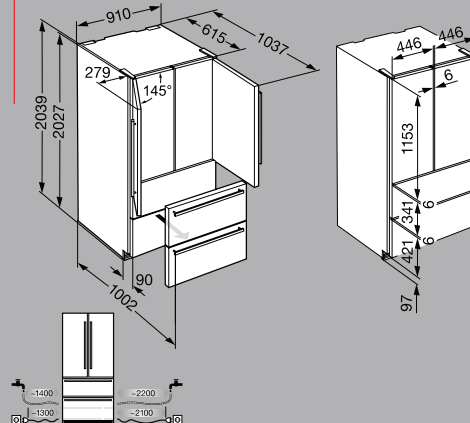

343 / 331

99 / 82

360 ¹

4

4

2

2

MagicEye with digital temp. display, touch electronic

+3°C to +9°C

-14°C to -28°C

SN-T

Visual and acoustic

Automatic

LED ceiling lighting

Acoustic

Right, reversible

185.9 / 74.7 / 63 ¹

95

220-240

220-240

Stainless steel with SmartSteel/silverl

Stainless steel with SmartSteel/silverl

Stainless steel with SmartSteel/silverl

Stainless steel with SmartSteel/silverl

Stainless steel with SmartSteel/silverl

Stainless steel with SmartSteel/silverl

Stainless steel with SmartSteel/silverl

Stainless steel with SmartSteel/silverl

Stainless steel with SmartSteel/silverl

Stainless steel with SmartSteel/silverl

Stainless steel with SmartSteel/silverl

Stainless steel with SmartSteel/silverl

Stainless steel with SmartSteel/silverl

Stainless steel with SmartSteel/silverl

Stainless steel with SmartSteel/silverl

Stainless steel with SmartSteel/silverl

Stainless steel with SmartSteel/silverl

Stainless steel with SmartSteel/silverl

Stainless steel with SmartSteel/silverl

Stainless steel with SmartSteel/silverl

Stainless steel with SmartSteel/silverl

Stainless steel with SmartSteel/silverl

Stainless steel with SmartSteel/silverl

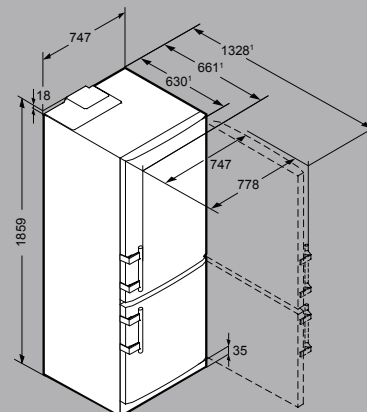

¹ To achieve the indicated energy consumption level, the wall spacers provided with the appliance must be used. These increase the appliance depth by approximately 3.5 cm. If the wall spacers are not used, the appliance will remain fully functional, but will have a slightly higher energy consumption level.



	<div>ECBN 6256 PremiumPlus</div> <div><div>Bio Fresh</div><div>No Frost</div><div>Duo Cooling</div><div>Ice Maker</div><div>Soft System</div></div>
Max. No. of Bordeaux bottles (0.75l) ²	-
Refrigerator capacity litre (gross/net)	402 / 364
BioFresh comp. litre (gross/net)	73 / 69 (Included in Fridge)
Freezer capacity litre (gross/net)	183 / 116
Energy consumption (kWh/y) ¹	517
Number of shelves refrigerator compartment	4
Number of shelves wine compartment	-
Number of door racks	6
Number of freezer drawers	2 with LED lighting
Number of BioFresh drawers	2 with LED lighting
Electronic control	MagicEye with digital temp. display, touch electronic
Refrigerator temperature range °C	+3°C to +9°C
Freezer temperature range °C	-14°C to -28°C
Climate class	SN-T
Temperature alarm	Visual and acoustic
Defrost type	Automatic
Interior light	LED light column on both sides and LED ceiling lighting
Door alarm	Acoustic
IceMaker	Fixed water connection 3/4"
Ice cube output kg/24h	1.3
SoftSystem	Yes
Door hinges	Left / right
Product dimensions (H/W/D) cm ¹	202.7 / 91 / 61
Net weight kg	161
Voltage V	220-240
Door/side walls	Steel
Installation Diagrams	



	IRBh 5120	ICNh 5103
	LED Wine Smart Steel	LED Cigar Smart Steel
Max. No. of Bordeaux bottles (0.75l) ²	2	1
Refrigerator capacity litre (gross/net)	215 / 195	190 / 182
BioFresh comp. litre (gross/net)	104 / 96	-
Freezer capacity litre (gross/net)	-	83 / 69
Energy consumption (kWh/y) ¹	164	-
Number of shelves refrigerator compartment	7	4
Number of shelves wine compartment	-	-
Number of door racks	2	-
Number of freezer drawers	-	3
Number of BioFresh drawers	3	-
Electronic control	Touch electronic	Touch electronic
Refrigerator temperature range °C	+3 °C to +9 °C	+2 °C to +9 °C
Freezer temperature range °C	+2 °C to +15 °C	-15 °C to -26 °C
Climate class	SN-T	SN-T
Temperature alarm	-	-
Defrost type	Automatic	Automatic
Interior light	LED ceiling light	LED ceiling light
Door alarm	Acoustical	Acoustical
IceMaker	No	No
Ice cube output kg/24h	-	-
SoftSystem	-	-
Door hinges	Right interchangeable	Right interchangeable
Product dimensions (H/W/D) cm ¹	177 / 55,9 / 54,6	177 / 55,9 / 54,6
Net weight kg	68.2	64.5
Voltage V	-	-
Door/side walls	Steel	Steel
Installation Diagrams		

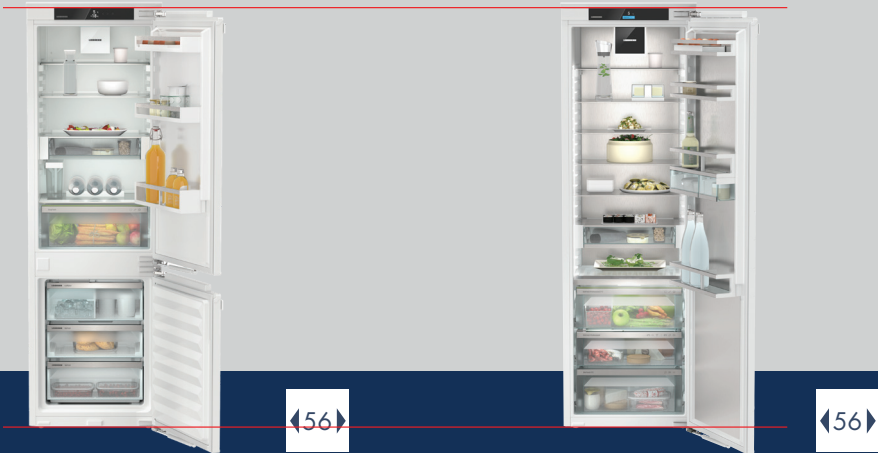

	ICNh 5133	IRBh 5170
	<div>LED</div> <div>Wine</div> <div>Smart Steel</div>	<div>LED</div> <div>Cigar</div> <div>Smart Steel</div>
Max. No. of Bordeaux bottles (0.75l) ²		
Refrigerator capacity litre (gross/net)	190 / 182	217 / 195
BioFresh comp. litre (gross/net)		104 / 92
Freezer capacity litre (gross/net)	83 / 67	
Energy consumption (kWh/y) ¹		164
Number of shelves refrigerator compartment	5	8
Number of shelves wine compartment		
Number of door racks	1	2
Number of freezer drawers	3	
Number of BioFresh drawers		3
Electronic control	Touch electronic	Touch & Swipe
Refrigerator temperature range °C	+2 °C to +9 °C	+3 °C to +9 °C
Freezer temperature range °C	-15 °C to -26 °C	+2 °C to +15 °C
Climate class	SN-T	SN-T
Temperature alarm	Acoustical	Acoustical
Defrost type	Automatic	Automatic
Interior light	LED ceiling light	Light panel both sides
Door alarm		
IceMaker	Yes	No
Ice cube output kg/24h	1.2	
SoftSystem		
Door hinges	Right interchangeable	Right interchangeable
Product dimensions (H/W/D) cm ¹	177 / 55,9 / 54,6	177 / 55,9 / 54,6
Net weight kg	71.2	79.2
Voltage V		
Door/side walls	Steel	Steel
Installation Diagrams		



56

		ICBNh 5173		
		LED	Wine	Smart Steel
Max. No. of Bordeaux bottles (0.75l) ²	-			
Refrigerator capacity litre (gross/net)	119 / 103			
BioFresh comp. litre (gross/net)	72 / 69			
Freezer capacity litre (gross/net)	83 / 67			
Energy consumption (kWh/y) ¹	-			
Number of shelves refrigerator compartment	4			
Number of shelves wine compartment	-			
Number of door racks	-			
Number of freezer drawers	3			
Number of BioFresh drawers	2			
Electronic control	Touch electronic			
Refrigerator temperature range °C	+3 °C to +9 °C			
Freezer temperature range °C	-15 °C to -26 °C			
Climate class	SN-T			
Temperature alarm	Acoustical			
Defrost type	Automatic			
Interior light	Light panel both sides			
Door alarm	-			
IceMaker	Yes			
Ice cube output kg/24h	1.2			
SoftSystem	-			
Door hinges	Left interchangeable			
Product dimensions (H/W/D) cm ¹	177 / 55,9 / 54,6			
Net weight kg	79.2			
Voltage V	-			
Door/side walls	Steel			
Installation Diagrams				

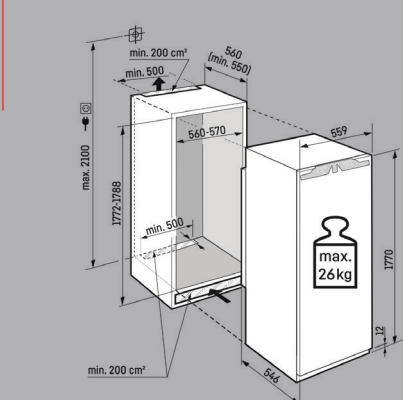

SIFNh 5128			SIFNh 5188		
LED	Wine	Smart Steel	LED	Wine	Smart Steel
Max. No. of Bordeaux bottles (0.75l) ²					
Refrigerator capacity litre (gross/net)					
BioFresh comp. litre (gross/net)					
Freezer capacity litre (gross/net)			249 / 209		
Energy consumption (kWh/y) ¹			398lIkWh/a		
Number of shelves refrigerator compartment					
Number of shelves wine compartment					
Number of door racks					
Number of freezer drawers			8		
Number of BioFresh drawers					
Electronic control			Touch electronic		
Refrigerator temperature range °C					
Freezer temperature range °C			-15 °C to -28 °C		
Climate class			SN-T		
Temperature alarm			Optical and acoustical		
Defrost type					
Interior light			LED		
Door alarm					
IceMaker					
Ice cube output kg/24h					
SoftSystem					
Door hinges			Left interchangeable		
Product dimensions (H/W/D) cm ¹			177 / 55,9 / 54,6		
Net weight kg			61.1lIkkg		
Voltage V			220-240		
Door/side walls			Steel		
Installation Diagrams					

Undercounter



◀60▶



◀60▶

SUIKO 1550 Premium

Soft
Telescopic

SUIKO 1510 Comfort

Soft
System

Max. No. of Bordeaux bottles (0.75l) ²
Refrigerator capacity litre (gross/net)
BioFresh comp. litre (gross/net)
Freezer capacity litre (gross/net)
Energy consumption (kWh/y) ¹
Number of shelves refrigerator compartment
Number of shelves wine compartment
Number of door racks
Number of freezer drawers
Number of BioFresh drawers
Number of fruit and vegetable drawers
Electronic control
Refrigerator temperature range °C
Freezer temperature range °C
Climate class
Temperature alarm
Defrost type
Interior light
Door alarm
IceMaker
Ice cube output kg/24h
SoftSystem
Door hinges
Product dimensions (H/W/D) cm ¹
Net weight kg
Voltage V
Door/side walls

136/124

BioFresh comp. litre (gross/net)

Freezer capacity litre (gross/net)

Energy consumption (kWh/y) ¹

Number of shelves refrigerator compartment

Number of shelves wine compartment

Number of door racks

Number of freezer drawers

Number of BioFresh drawers

Number of fruit and vegetable drawers

Electronic control

Refrigerator temperature range °C

Freezer temperature range °C

Climate class

Temperature alarm

Defrost type

Interior light

Door alarm

IceMaker

Ice cube output kg/24h

SoftSystem

Door hinges

Product dimensions (H/W/D) cm ¹

Net weight kg

Voltage V

Door/side walls

158

Number of shelves refrigerator compartment

Number of shelves wine compartment

Number of door racks

Number of freezer drawers

Number of BioFresh drawers

Number of fruit and vegetable drawers

Electronic control

Refrigerator temperature range °C

Freezer temperature range °C

Climate class

Temperature alarm

Defrost type

Interior light

Door alarm

IceMaker

Ice cube output kg/24h

SoftSystem

Door hinges

Product dimensions (H/W/D) cm ¹

Net weight kg

Voltage V

Door/side walls

MagicEye with LCD temp. display, key electronic

+2°C to +9°C

SN-T

Automatic

LED ceiling lighting

Visual and acoustic

Pull-out

82-88/59.7/55

41.5

220-240

Steel

141/136

BioFresh comp. litre (gross/net)

Freezer capacity litre (gross/net)

Energy consumption (kWh/y) ¹

2

Number of shelves refrigerator compartment

Number of shelves wine compartment

Number of door racks

Number of freezer drawers

Number of BioFresh drawers

Number of fruit and vegetable drawers

Electronic control

Refrigerator temperature range °C

Freezer temperature range °C

Climate class

Temperature alarm

Defrost type

Interior light

Door alarm

IceMaker

Ice cube output kg/24h

SoftSystem

Door hinges

Product dimensions (H/W/D) cm ¹

Net weight kg

Voltage V

Door/side walls

147

2

Number of shelves refrigerator compartment

Number of shelves wine compartment

Number of door racks

Number of freezer drawers

Number of BioFresh drawers

Number of fruit and vegetable drawers

Electronic control

Refrigerator temperature range °C

Freezer temperature range °C

Climate class

Temperature alarm

Defrost type

Interior light

Door alarm

IceMaker

Ice cube output kg/24h

SoftSystem

Door hinges

Product dimensions (H/W/D) cm ¹

Net weight kg

Voltage V

Door/side walls

MagicEye with LCD temp. display, key electronic

+2°C to +9°C

SN-T

Automatic

LED interior lighting

Visual and acoustic

Yes

Right, reversible

82-88/59.7/55

34.5

220-240

Steel

Installation Diagrams

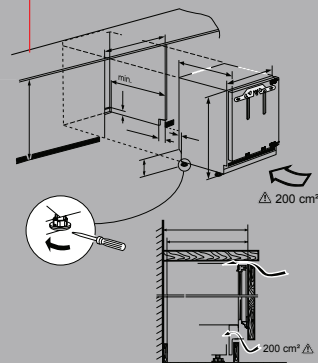
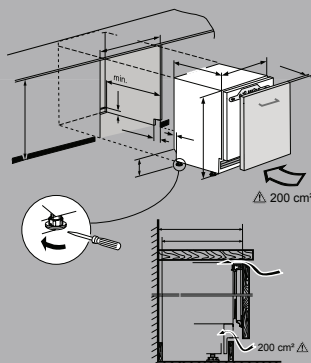

Freestanding Wine Cabinets

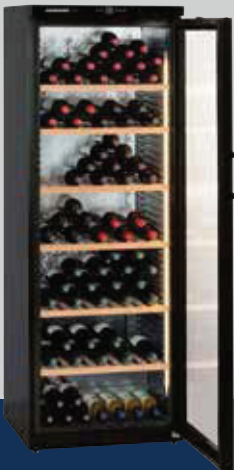

	<div> <div>Wkb 4612</div> <div>Barrique</div> </div> <div> <div>LED</div> <div>Wine</div> </div>
Max. No. of Bordeaux bottles (0.75l) ²	195
Total capacity litre (gross / net)	453 / 336
Energy consumption (kWh / y)	204
Number of shelves	7
Shelves on telescopic rails	-
Shelf material	Beech wood shelves
Presentation shelf	1
Electronic control	MagicEye with digital temp. display, key electronic
Temperature range °C	+5°C to +20°C
Climate class	SN-T
Temperature zones	1
Temperature alarm	Visual and acoustic
Interior light	LED interior lighting
Door alarm	Acoustic
Safety thermostat	Yes
Activated charcoal filter	Yes
Integrated lock	Yes
SoftSystem	-
Door hinges	Right, reversible
Product dimensions (H/W/D) cm	184.2 / 65.7 / 66.3
Net weight kg	86
Voltage V	220–240
Door type	Glass door with handle, frame black
Installation Diagrams	

1 To achieve the indicated energy consumption level, the wall spacers provided with the appliance must be used. These increase the appliance depth by approximately 3.5 cm. If the wall spacers are not used, the appliance will remain fully functional, but will have a slightly higher energy consumption level.

2 These models are only bound for storing wine. Maximum DIN norm bordeaux bottles capacity (0.75 l) as per norm NF H 35-124 (H: 300.5 mm, Ø 76.1 mm).

Freestanding Wine Cabinets

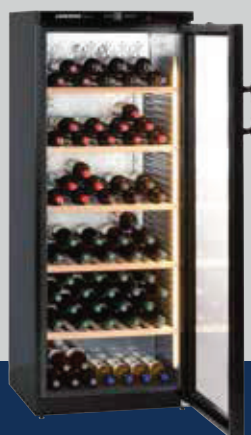

«66»



«66»

WKb 4112 Barrique

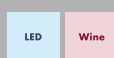

WKb 1712 Barrique

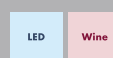

Max. No. of Bordeaux bottles (0.75l) ²
Total capacity litre (gross / net)
Energy consumption (kWh / y)
Number of shelves
Shelves on telescopic rails
Shelf material
Presentation shelf
Electronic control
Temperature range °C
Climate class
Temperature zones
Temperature alarm
Interior light
Door alarm
Safety thermostat
Activated charcoal filter
Integrated lock
SoftSystem
Door hinges
Product dimensions (H/W/D) cm
Net weight kg
Voltage V
Door type

168
395/293
178
6
-
Beech wood shelves
1
MagicEye with digital temp. display, key electronic
+5°C to +20°C
SN-T
1
Visual and acoustic
LED interior lighting
Acoustic
Yes
Yes
Yes
Yes
-
Right, reversible
164.5/65.7/66.3
78
220-240
Glass door with handle, frame black

60
173 / 121
149
3
-
Beech wood shelves
-
MagicEye with digital temp. display, key electronic
+5°C to +20°C
SN-T
1
Visual and acoustic
LED interior lighting
Acoustic
Yes
Yes
Yes
Yes
-
Right, reversible
85/65.7/66.3
45
220-240
Glass door with handle, frame black

Installation Diagrams

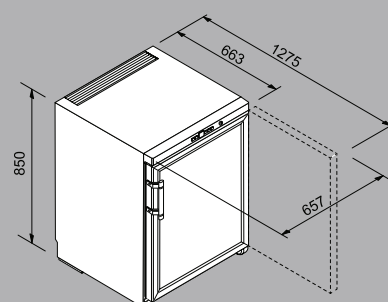
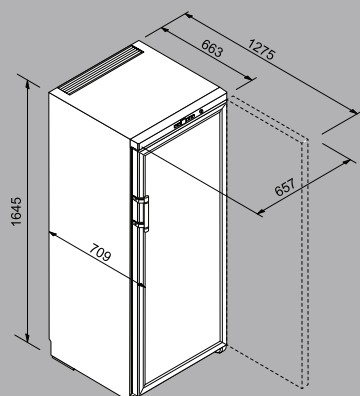

Fully Integrated Wine Cabinets



◀56▶



◀60▶



◀60▶

	EWTdf 3553 Vinidor				UWTgb 1682 Vinidor					UWTes 1672 Vinidor		
	LED	Wine	Soft System	Telescopic Rails	LED	Wine	Tip Open	Soft System	Telescopic Rails	LED	Wine	Telescopic Rails
Max. No. of Bordeaux bottles (0.75l) ¹												
Total capacity litre (gross/net)												
Energy consumption (kWh/y)												
Number of shelves												
Shelves on telescopic rails												
Shelf material												
Presentation shelf												
Electronic control												
Temperature range °C												
Climate class												
Temperature zones												
Temperature alarm												
Interior light												
Door alarm												
Safety thermostat												
Activated charcoal filter												
Integrated lock												
SoftSystem												
Door hinges												
Product dimensions (H/W/D) cm												
Net weight kg												
Voltage V												
Door type												
Installation Diagrams	<p>* Recommended: 560 mm ** Image shows stainless steel frame fitted</p>											

¹ These models are only bound for storing wine. Maximum DIN norm bordeaux bottles capacity (0.75 l) as per norm NF H 35-124 (H: 300.5 mm, Ø 76.1 mm).

Fully Integrated Wine Cabinet

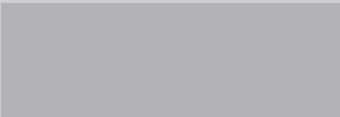

WKEgb 582

LED	Wine	Tip Open	Soft System	Telescopic Rails
-----	------	-------------	----------------	---------------------

Max. No. of Bordeaux bottles (0.75l) ²	18
Total capacity litre (gross / net)	48/46
Energy consumption (kWh / y)	106
Number of shelves	3
Shelves on telescopic rails	2
Shelf material	Beech wood shelves
Presentation shelf	-
Electronic control	LCD temp. display, touch electronic
Temperature range °C	+5°C to +20°C
Climate class	SN-ST
Temperature zones	1
Temperature alarm	Visual and acoustic
Interior light	LED lighting permanently on, dimmable
Door alarm	Acoustic
Safety thermostat	Yes
Activated charcoal filter	Yes
Integrated lock	-
SoftSystem	-
Door hinges	Folding door
Product dimensions (H/W/D) cm	44.8/55.5/55.9
Net weight kg	33
Voltage V	220–240
Door type	Black insulated glass door, handle and frame free

Installation Diagrams

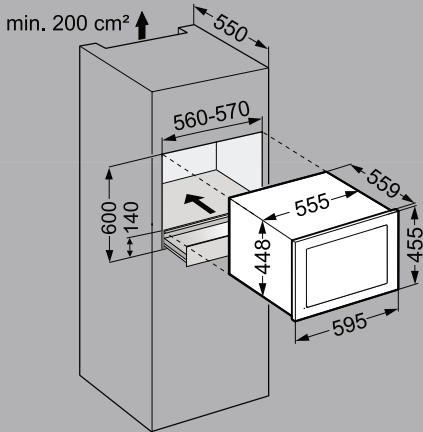



◀43▶

FKv 503

LED

Cigar

Smart Steel

Max. No. of Bordeaux bottles (0.75l) ²	-
Total capacity litre (gross / net)	-
Energy consumption (kWh / y)	284
Number of shelves	2
Shelves on telescopic rails	-
Shelf material	-
Presentation shelf	-
Electronic control	Touch & Swipe
Temperature range °C	+2 °C to +12 °C
Climate class	SN-T
Temperature zones	-
Temperature alarm	-
Interior light	LED ceiling light
Door alarm	-
Safety thermostat	-
Activated charcoal filter	-
Integrated lock	-
SoftSystem	-
Door hinges	Right fix
Product dimensions (H/W/D) cm	61.2 / 42.5 / 45
Net weight kg	30
Voltage V	-
Door type	Glass with stainless steel trim

Installation Diagrams

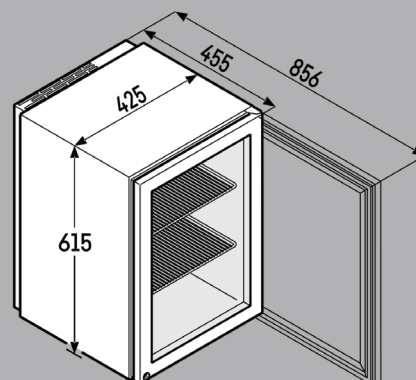



Click the link to directly access
our social media channels:
socialmedia.home.liebherr.com



blog.liebherr.com



Facebook.com/LiebherrAppliancesIndia



x.com/LiebherrHomeIN



Instagram.com/LiebherrAppliancesIndia

Liebherr Appliances India Pvt. Ltd.
A1/6 Shendra MIDC, Jalna Road, Aurangabad - 431 154, Maharashtra, India
Customer Care: 7038 100 400
E-mail: customercare.lhi@liebherr.com